

# TECHNICAL DATA

**LIBERTY HARDWARE®**  
MANUFACTURING CORPORATION

A Masco Company

140 Business Park Drive • Winston-Salem, NC 27107  
800.542.3789 • T 336.769.4077 • F 336.769.1839  
www.libertyhardware.com

## RECESSED DOUBLE TOILET PAPER HOLDER

977 & 979 Series

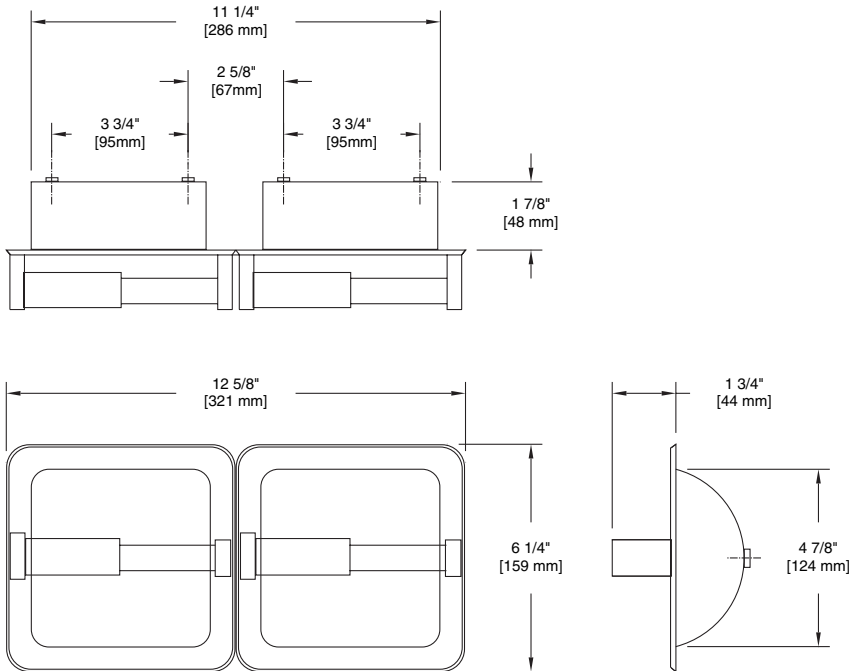

**MATERIALS:**

Stainless steel recess shells are stamped from 22 gauge corrosion resistant type 304 stainless steel and are polished or satined. Projecting posts are die cast from highest quality virgin zinc alloy (Zamak) to meet ASTM standard B-86. Castings are highly polished and plated with chrome or satin chrome. Roller material as listed under each model number. All rollers are spring actuated. Recess shells are pre-assembled using a 14 gauge galvanized steel clip and 4 machine screws.

**INSTALLATION:**

Cut out wall opening 11 3/4" x 5 1/4" x 2" depth (5 1/4" x 11 3/4" x 2" depth for 979). If wood blocking available install recess shell into opening using 4- #8 x 1 1/4" flathead stainless steel screws provided. If wood blocking is not available use 2 optional 600R recess wall clamps for each 977 and 2 optional 601R recess wall clamps for each 979.

**SPECIFICATION:**

Recess double paper holder shall be model \_\_\_\_\_ (fill in model number) by Liberty Hardware Manufacturing Corporation.